

Rocket Man M1002 Operating Manual



For Information or Service:

Rocket Man Equipment Company

103 N. 32nd St

Louisville, KY 40212 USA

www.rocketman.com

Email to: sales@rocketman.com

Call Toll Free: 800-921-0199 Fax us at 502-775-7519

INTERNATIONAL CALLING: 502-774-1499



Greetings:

Thank you for your business!

We sincerely believe that once you use the ***Rocket Man Backpack Drink Dispenser*** to promote your beverage products, you will share our enthusiasm for its unique ability to increase profits.

The purpose of this manual is to clearly explain the current standards of operation and provide the basis for maintaining consistency and uniformity of beverage quality.

I encourage you to consult our website from time to time at **www.rocketman.com**. We are constantly updating and improving the operating manual and adding new products and services.

If you have questions or need more information, our team can help you at anytime by telephone, fax, or e-mail.

Thanks again for your business.

Sincerely,

Mike Hinson, President
Rocket Man Equipment Company



TABLE OF CONTENTS

A) What Is Included.....	
B) Accessories	
C) Fitting Backpack Harness Assembly	
D) Ten Easy Steps To Fill Beverage Tank	
E) Cleaning and Sanitization of the Equipment.....	
F) Troubleshooting.....	
G) Warranty and Registration.....	
H) Spare Parts.....	

A. WHAT IS INCLUDED







Each **Rocket Man** M1002 Backpack Drink Dispenser comes with the following:

- 2.5 Gallon (9.5 Liters) Stainless Steel Beverage Tank
- Backpack cover with state-of-the-art insulation
- Backpack harness with shoulder straps, hip belt and lumbar support
- Sign compartment
- Cup dispenser
- Dispensing Hose & Gun

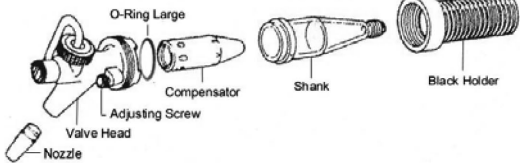

You will need to purchase a Rocket Pump (#1130) separately.

B. ACCESSORIES

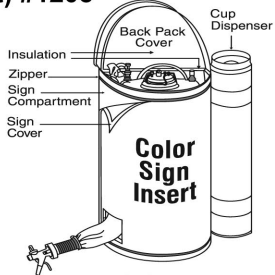
 <p>Rocket Pump #1130</p> <p>The Rocket Pump is used to pressurize the Beverage Tank.</p>	 <p>Spare Beverage Tank (3 gallon) #1110</p> <p>Minimize downtime by pre-filling spare tanks.</p>
 <p>Custom Sign Insert #1118</p> <p>Height: 17 inches; Width: 28 inches. Four-color process. Customer provides artwork on disc.</p>	 <p>Apron #1113</p> <p>Enables the operator to carry money, coupons, straws, lids, condiments, etc.</p>
<p>Dispenser Hose & Gun #1202</p>  <p>O-Ring Large Compensator Shank Black Holder Valve Head Adjusting Screw Nozzle</p>	 <p>Cleaning Solution #1112</p> <p>Specifically designed for cleaning stainless steel foodservice equipment and beverage lines.</p>
<p>Sign Cover (Replacement) #1208</p>  <p>Insulation Zipper Sign Compartment Sign Cover Back Pack Cover Cup Dispenser Color Sign Insert</p>	

C. *FITTING BACKPACK HARNESS ASSEMBLY*

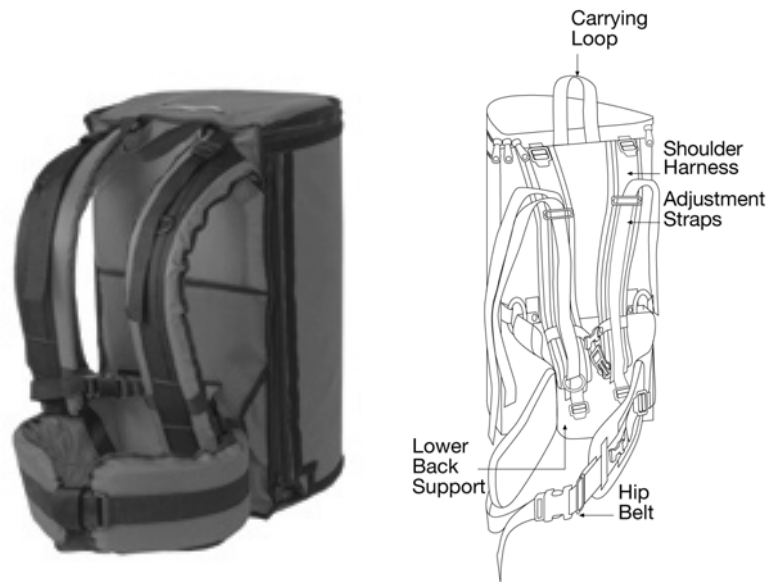

1. Loosen straps on harness assembly.
2. Place backpack over the person's shoulders – slip shoulder straps over arms.
3. Connect the hip belt around the person's waist and pull straps tight so that the hip bears most of the weight
4. Tighten shoulder and chest straps (not shown).
5. Tuck in loose straps for a neat appearance.

D. TEN EASY STEPS TO FILL BEVERAGE TANK



1. Release pressure in the *Beverage Tank* by opening the *Pressure Release Valve* on the *Tank Lid* (You will hear a “hissing” noise as air escapes). Close the valve back after pressure has been released.
2. To remove the *Tank Lid*, pull the latch up. Then, push the *Tank Lid* down and turn it 90 degrees. Pull *Tank Lid* up and out.
3. Pour up to 2 ½ gallons (9.4 Liters) of liquid into the 3 Gallon *Beverage Tank* **four inches from the top**. Replace the *Tank Lid* and push down on the latch to lock into place. Make sure the lid and gasket are properly aligned and tightened.
4. Connect the *Grey Quick Disconnect “IN”* from the *Rocket Pump* to the “IN” valve on the *Beverage Tank* (See Video for operating hints).
5. Place foot on bottom of *Rocket Pump* and begin pumping.
6. Once the gauge reaches 60 p.s.i., the *Beverage Tank* is fully pressurized. Disconnect the *Grey Quick Disconnect “IN”* from *Rocket Pump*.
7. Thread *Dispensing Hose* up through *Exit Hole*.
8. Insert the *Beverage Tank* **upright** into the Backpack.
9. Connect the *Black Quick Disconnect “OUT”* from the *Dispensing Hose* to the “OUT” valve on the *Beverage Tank*.
10. Dispense liquid from the *Dispensing Gun* by squeezing the trigger. Turn the adjusting screw clockwise to decrease the flow or counter-clock wise to increase flow. **CAUTION: The screw may come off if it is loosened too much.**

E. CLEANING AND SANITIZATION (RECOMMENDED AFTER EACH EVENT)

1. Rinse out the *Beverage Tank* with hot water (130 degrees Fahrenheit).
2. Pour ½ gallon of hot water into the *Beverage Tank* and add a cleaning concentrate (suitable for stainless steel foodservice equipment).
3. Replace the *Tank Lid* and pull the latch down to lock into place.
4. Shake the *Beverage Tank* vigorously for ten seconds. Allow solution to remain in the *Beverage Tank* for an additional three minutes.
5. Pressurize the *Beverage Tank* with the *Rocket Pump* (See Steps 4, 5 & 6 in Section D).
6. Connect the *Dispensing Hose* to the *Beverage Tank* (See Step 9 in Section D).
7. Flush all of the liquid through the *Dispensing Hose* by squeezing the trigger on the *Dispensing Gun*.
8. Remove the *Tank Lid* and rinse out the remains of the cleaning concentrate. Pour an additional ½ gallon of hot water into the *Beverage Tank* (Do not add cleaning solution).
9. Repeat Steps 5,6 & 7. Flush all of the water through the *Dispensing Hose* and *Gun*.
10. Cleaning and sanitation is complete. Allow *Beverage Tank* to dry before replacing lid.

F. TROUBLESHOOTING – NO LIQUID COMES OUT

- Check the connection of the *Dispensing Hose* (Black Quick Disconnect “OUT” Fitting) on the “OUT” valve of the Beverage Tank to be sure its properly connected.
- Increase the flow rate by turning the adjusting screw (See diagram below) on the *Dispensing Gun* counter-clockwise. DO NOT REMOVE ENTIRELY.
- Increase pressure in the *Beverage Tank* to 65 psi
- Be sure the latch on *Tank Lid* is shut tightly and the *Pressure Release Valve* is closed to prevent compressed air from escaping.
- Check the dilution of beverage concentrates as improperly mixed syrups, powders, and concentrates can clog the *Dispensing Hose and Gun*. Remove coffee grounds, if necessary.

IF THE DISPENSER HOSE/GUN LEAK:

- If leak comes from the base of dispenser gun: Dismantle gun and tighten fittings
- If leak comes from black quick disconnect fitting: tighten fitting
- If leak comes from inside of the insulation on the dispensing hose, contact Rocket Man to obtain return authorization.



G. *Warranty*

Full Three Year Warranty On All Components

For three years from the date of purchase, Rocket Man, Inc. will repair or replace any component, free of charge, if defective in material or workmanship.

Repairs necessitated by normal wear, accident, improper care or negligence, are not covered under this guarantee, and products returned under these conditions will be repaired or replaced for a reasonable charge.

Warranty registration is not necessary to receive the privileges of the Warranty.

H. Spare Parts

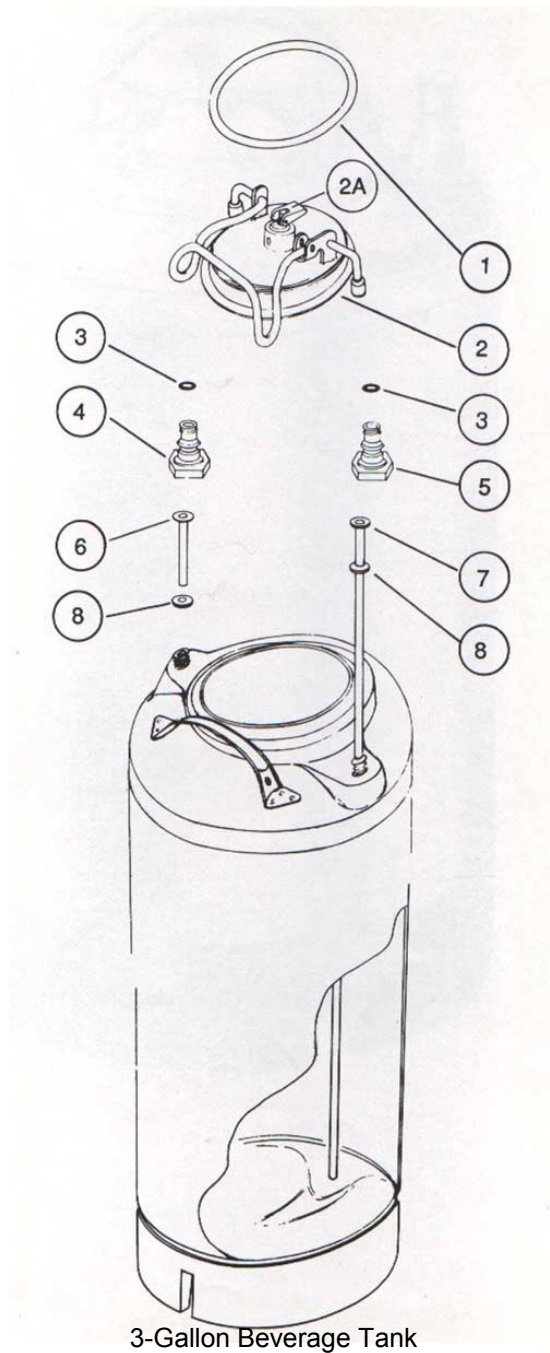

SPARE PARTS FOR 3 GALLON BEVERAGE TANK:		
Description	Item #	Diagram #
Complete Beverage Tank	1110	All
Black O-Ring	1110-02	1
Lid	1110-12	2
Purge Device	1110-13	2-a
Gasket for Plugs	1110-01	3
Inlet Plug Assembly	1110-06	4
Outlet Plug Assembly	1110-07	5
Metal Level Tube (L: 1-3/16")	1110-10	6
Dip Tube	1110-09	7
O Ring for Level and Dip Tubes	1110-08	8
Outlet Boss	1110-04	9
Inlet Boss	1110-05	10

DISPENSING GUN

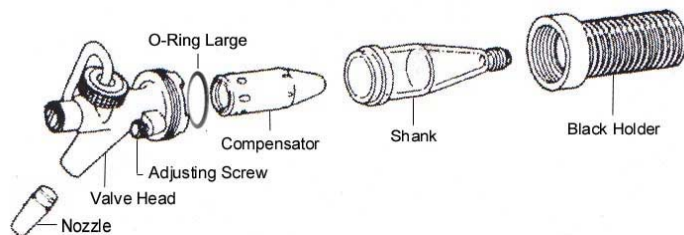

Spare Parts For Dispensing Gun:	
Description	Item #
Complete Squeeze Valve	1201
Adjusting Screw	1201-13
Nozzle	1201-03
Compensator	1201-11
Shank (1/2 inch)	1201-16
Valve Head Assembly	1201-15
O-Ring (Large)	1201-17